

Product Specifications

2. Product Specifications

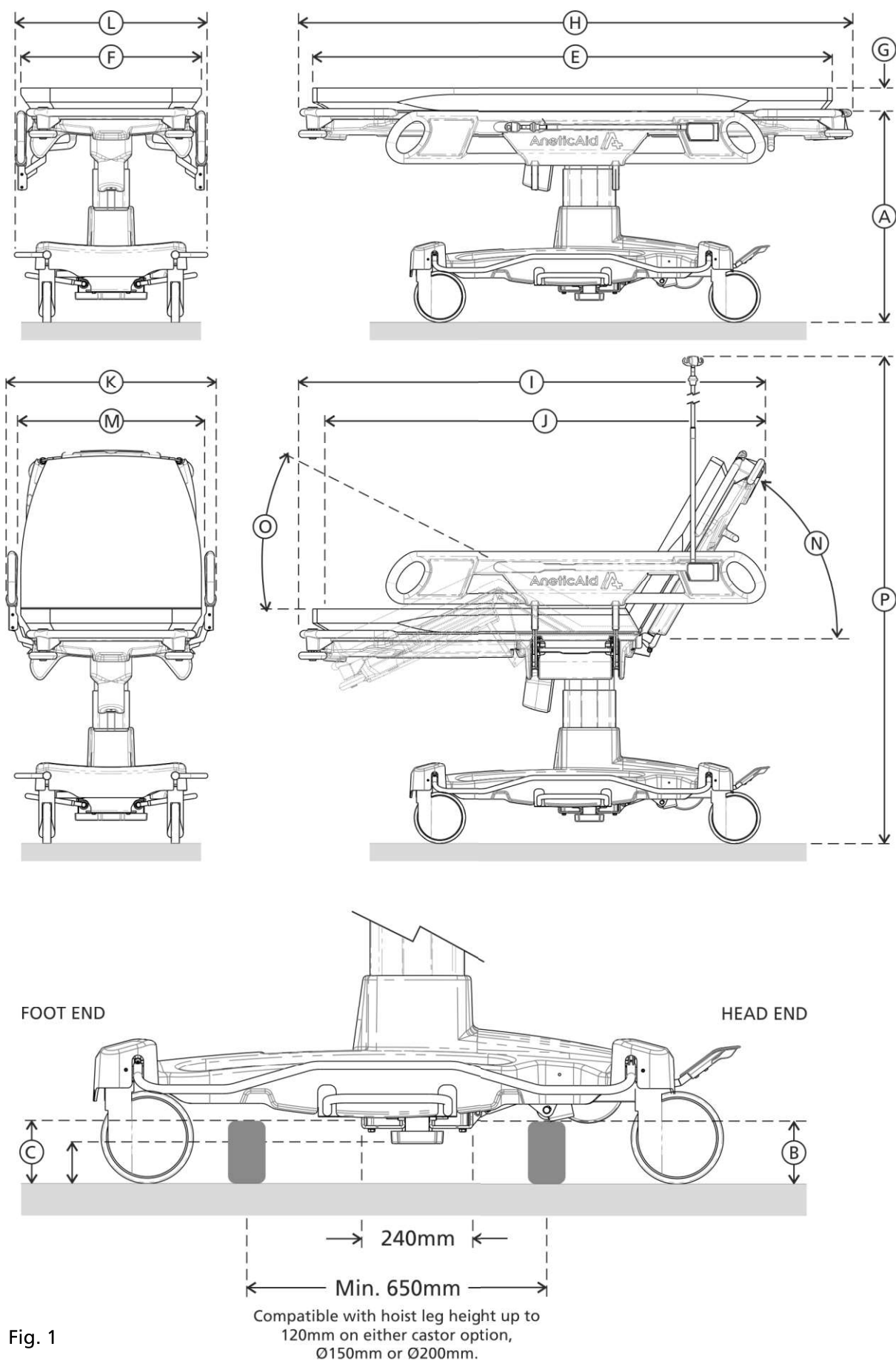

Fig. 1

Product Specifications

Key to Fig. 1		QA3 Patient Trolley (and build options)		QA3 Emergency Trolley (and build options)	
Castor Diameter		Ø150mm (5.9")	Ø200mm (7.9")	Ø150mm (5.9")	Ø200mm (7.9")
NOTE: Ø150mm are the standard option, Ø200mm is a build option.					
Height Range:					
A.	Minimum Trolley Height	475mm (18.7")	520mm (20.5")	535mm (21.1")	580mm (22.8")
	Maximum Trolley Height	775mm (30.5")	820mm (32.3")	835mm (32.9")	880mm (34.6")
NOTE: Height is measured from the floor to the patient platform and does not include the mattress.					
Ground Clearances Under the Trolley Base:					
B.	Under the 5 th Wheel Pedal Mechanism, Head End	90mm (3.5")	90mm (3.5")	90mm (3.5")	90mm (3.5")
C.	Under the Base Frame, Foot End	90mm (3.5")	135mm (5.3")	90mm (3.5")	135mm (5.3")
D.	Under the Lifting Column	44mm (1.7")	90mm (3.5")	44mm (1.7")	90mm (3.5")
NOTE: The ground clearance figures quoted are general guidelines; as per Fig.1 the trolley is compatible with hoists with leg heights up to 120mm on either castor option, Ø150 or Ø200mm.					
Mattress Dimensions (standard) and <800> Mattress (build option):					
E.	Std. Mattress Length	2025mm (79.7")			
	<800> Mattress Length				
F.	Std. Mattress Width	700mm (27.6")			
	<800> Mattress Width				
G.	Std. Mattress Depth	90mm (3.5")			
	<800> Mattress Depth				
NOTE: Refer to Section 37, 'K8 Pressure Care Mattress', for full specification details.					
Trolley Length:					
H.	Patient Platform Flat	2150mm (84.6")			
I.	Backrest Raised	1820mm (71.7")			
J.	Backrest & KneeFlex Raised	1700mm (66.9")			
Trolley Widths (standard) and <800> (build option) :					
K.	Side Rails Up (std.)	805mm (31.7")			
	Side Rails Up (<800>)				
L.	Side Rails Down (std.)	735mm (28.9")			
	Side Rails Down (<800>)				
	Brakes Off				
M.	Width between Side Rails Up (std.)	745mm (29.3")			
	Width between Side Rails Up (<800>)				
Backrest & KneeFlex Articulations:					
N.	Manual Function Backrest	0 - 90°			
	Powered Function Backrest				
O.	KneeFlex	0 - 30°		N/A	
IV Pole:					
P.	Maximum Height of Pole	2110mm (83.1")		2155mm (84.8")	
	Maximum Weight per Hook	3kg (6.6lbs) or 3 Litres (101.4 fl oz.)			
	Safe Working Load	6kg (13lb)			
Trendelenburg:					
Trendelenburg		12°			
Reverse Trendelenburg		10°			
NOTE: Trendelenburg is a standard trolley function, Reverse Trendelenburg is an optional function.					

Product Specifications

Patient Weight Limit and Safe Working Load (SWL):		
Maximum Patient Weight	320kg (705.5lbs)	
Safe Working Load (SWL)	320kg (705.5lbs)	
NOTE: Refer to Section 36, 'Patient Weight Limit', for more information about maximum patient weight limit, safe working load and special precautions when handling heavy patients.		
Trolley Weights:		
Code 21110 / Code 21120	128.0kg (282.2lbs)	148.0kg (326.3lbs)
Code 21112 / Code 21122	143.5kg (316.4lbs)	157.0kg (346.1lbs)
Code 21114 / Code 21124	148.0kg (326.3lbs)	162.5kg (358.3lbs)
Code 21116 / Code 21126	141.0kg (310.9lbs)	154.5kg (340.6lbs)
NOTE: Fitting the Ø200mm castor option adds 2kg to the total trolley weight.		

DRIVE Assist Function:	
DRIVE Assist range	> 20km (12.4 miles)
NOTE: This figure is a guide only, and will vary depending upon a number of conditions, i.e.; patient weights, the number and severity of inclines, battery age, etc.	
Maximum slope angle	6°
DRIVE Handle deactivation	3 minutes
System switch off	30 minutes

Battery Type, Mains Charging Input, Charging Times:	
Battery specification	NiMH, 9Ah 24V
Mains charging input	100-240V~, 50-60Hz.  T2.5A 250V 20mm
Full charge time from flat	5hrs
Partial charge time	30 minutes per 10% of the full charge
NOTE: The charging figures quoted are dependent upon the age and condition of the battery, and are guidelines only.	

IP Rating:	IPX4
------------	------

Environmental Conditions:		
Temperature:	Operation	10°C to 50°C
	Storage & Transport	-20°C to 50°C
Relative Humidity:	Operation	30% to 75%
	Storage & Transport	10% to 75%
Atmospheric Pressure:	Operation	70kPa to 106kPa
	Storage & Transport	50kPa to 106kPa

Environmental Regulatory Information; WEEE, waste batteries, etc.:
For the latest information about Anetic Aid's environmental policy, WEEE policy, and the safe disposal of this product, please refer to our website.

NOTE: All dimensions quoted are subject to the following tolerances; angles $\pm 5^\circ$, lengths and widths $\pm 25\text{mm}$, depths $\pm 10\text{mm}$. Anetic Aid reserves the right to change specifications without notice.